

Data Sheet

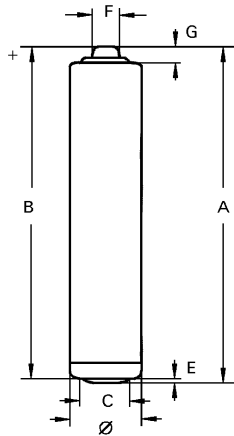

Type Designation	4003
Designation IEC System	LR03 Zn-MnO ₂ (Alkaline)
Shelf Life (Coding)*	10 years
Nominal Voltage [V]	1.5
Typical Capacity C [mAh]	1270 (discharge with high-resistance)
Permissible Temperature Range	- 20 °C ... 50 °C
Weight, approx. [g]	11,4
Volume [ccm]	3.8
Specific Energy [Wh/kg]	136

Dimensions [mm]

	min:	max:
Ø	9.5	10.5
A	-	44.5
B	43.3	-
C	4.3	-
E	-	0.5
F	-	3.8
G	0.8	-

Typical Capacities (at 20°C):

Discharge Type	Load	End Voltage[V]	0.9
1H/12H, 7D/W	50 mA	Time [h]	22,8
Digital audio		Capacity [mAh]	1142
		Energy [mWh]	1417
Discharge Type	Load	End Voltage[V]	0.9
4M/H, 8H/D, 7D/W	5,1 Ω	Time [min]	263
Portable lighting		Capacity [mAh]	1002
		Energy [mWh]	1180
Discharge Type	Load	End Voltage[V]	0.8
1H/D 7D/W	5,1 Ω	Time [min]	285
Toy		Capacity [mAh]	1027
		Energy [mWh]	1180

* In consideration of typical loss of capacity at storage and application.

*Information and contents in this data sheet are for reference purpose only.
They do not constitute any warranty or representation and are subject to change without notice.
For most current information and further details, please contact your VARTA representative.*

Data Sheet

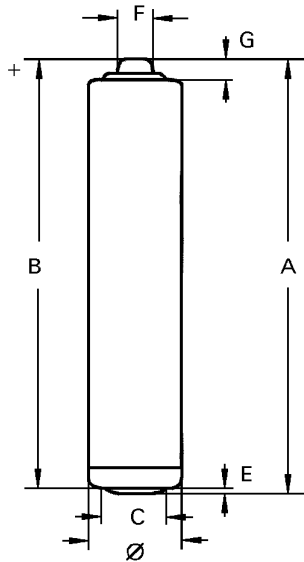

Type Designation	4006
Designation IEC	LR06
System	Zn-MnO ₂ (Alkaline)
Shelf Life (Coding)*	10 years
Nominal Voltage [V]	1.5
Typical Capacity C [mAh]	2970 (discharge with high-resistance)
Permissible Temperature Range	- 20 °C ... 50 °C
Weight, approx. [g]	23,8
Volume [ccm]	7.5

Dimensions [mm]

min: max:

∅	13.5	14.5
A	-	50.5
B	49.2	-
C	7.0	-
E	-	0.5
F	-	5.5
G	1.0	-

Typical Capacities (at 20°C):

Discharge Type	Load	End Voltage[V]	1.0
1H/8H, 24H/D,7D/W Radio / Clock / Remote Control	50 mA	Time [h]	53,0
		Capacity [Ah]	2,65
		Energy [Wh]	3,40
Discharge Type	Load	End Voltage[V]	0.9
1H/D,7D/W Toy, non-motorized	250 mA	Time [h]	8,8
		Capacity [Ah]	2,05
		Energy [Wh]	2,65
Discharge Type	Load	End Voltage[V]	0.9
4M/H, 8H/D, 7D/W Portable Lighting	3,9 Ω	Time [min]	463
		Capacity [Ah]	2,36
		Energy [Wh]	2,86

* In consideration of typical loss of capacity at storage and application.

Information and contents in this data sheet are for reference purpose only.
 They do not constitute any warranty or representation and are subject to change without notice.
 For most current information and further details, please contact your VARTA representative.

Data Sheet

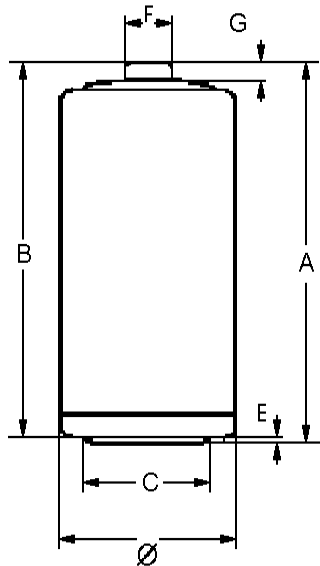

Type Designation	4014
Designation IEC System	LR14 Zn-MnO ₂ (Alkaline)
Shelf Life (Coding)*	10 years
Nominal Voltage [V]	1.5
Typical Capacity C [mAh]	7800 (discharge with high-resistance)
Permissible Temperature Range	- 20 °C ... 50 °C
Weight, approx. [g]	65,8
Volume [ccm]	26

Dimensions [mm]

min: max:

∅	24.9	26.2
A	-	50.0
B	48.6	-
C	13.0	-
E	-	0.9
F	-	7.5
G	1.5	-



Typical Capacities (at 20°C):

Discharge Type	Load	End Voltage[V]	0.9
4M/15M,8H/D,7D/W	3.9 Ω	Time [h]	22,1
Portable Lighting		Capacity [Ah]	6,44
		Energy [Wh]	7,38
Discharge Type	Load	End Voltage[V]	0.8
1H/D,7D/W	3.9 Ω	Time [h]	24,7
Toy		Capacity [Ah]	6,80
		Energy [Wh]	7,39
Discharge Type	Load	End Voltage[V]	0.9
2H/D,7D/W	400 mA	Time [h]	11,5
Portable stereo		Capacity [Ah]	4,60
		Energy [Wh]	5,02

* In consideration of typical loss of capacity at storage and application.

Information and contents in this data sheet are for reference purpose only.
 They do not constitute any warranty or representation and are subject to change without notice.
 For most current information and further details, please contact your VARTA representative.

VARTA Microbattery GmbH, VARTA-Platz 1, D-73479 Ellwangen/Jagst
 Tel.: (+49) 7961/921-0, Telefax: (+49) 7961/921-2553

Subject to change without prior notice!
 Date of issue: 2020-08-20

Data Sheet

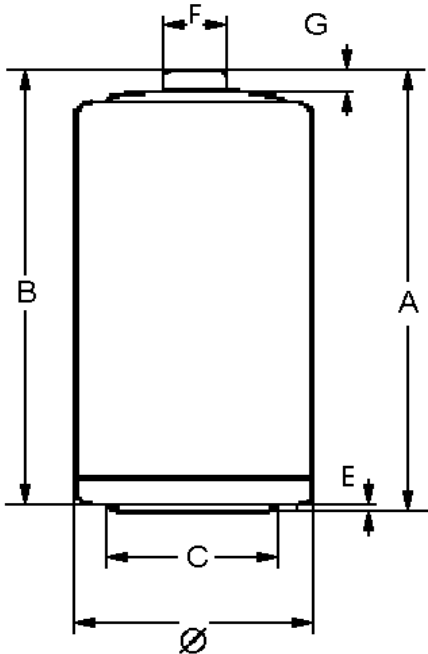

Type Designation	4020
Designation IEC	LR20
System	Zn-MnO ₂ (Alkaline)
Shelf Life (Coding)*	10 years
Nominal Voltage [V]	1.5
Typical Capacity C [mAh]	17000 (discharge with high-resistance)
Permissible Temperature Range	- 20 °C ... 60 °C
Weight, approx. [g]	140,4
Volume [ccm]	51.3

Dimensions [mm]	min:	max:
∅	32.3	34.2
A	-	61.5
B	59.5	-
C	18.0	-
E	-	1.0
F	-	9.5
G	1.5	-

Typical Capacities (at 20°C)

4M/15M,8H/D,7D/W	2.2 Ω	Time [h]	27,1
Portable lighting		Capacity [Ah]	14,1
		Energy [Wh]	16,3
Discharge Type	Load	End Voltage[V]	0.8
1H/D,7D/W	2.2 Ω	Time [h]	29,7
Toy		Capacity [Ah]	14,7
		Energy [Wh]	16,2
Discharge Type	Load	End Voltage[V]	0.9
2H/D,7D/W	600 mA	Time [h]	18,8
Portable Stereo		Capacity [Ah]	11,3
		Energy [Wh]	12,5

* In consideration of typical loss of capacity at storage and application.

Information and contents in this data sheet are for reference purpose only.
 They do not constitute any warranty or representation and are subject to change without notice.
 For most current information and further details, please contact your VARTA representative.

VARTA Microbattery GmbH, VARTA-Platz 1, D-73479 Ellwangen/Jagst
 Tel.: (+49) 7961/921-0, Telefax: (+49) 7961/921-2553

Subject to change without prior notice!
 Date of issue: 2020-08-20

Data Sheet

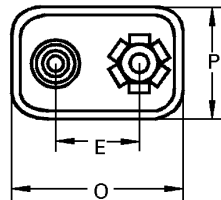
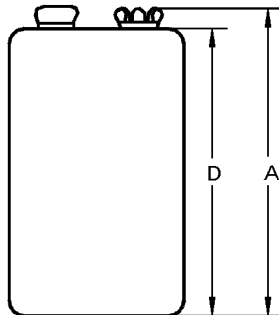

Type Designation	4022
Designation IEC	6LR61
System	Zn-MnO ₂ (Alkaline)
Shelf Life (Coding)*	5 years
Nominal Voltage [V]	9
Typical Capacity C [mAh]	640 (discharge with high-resistance)
Permissible Temperature Range	- 20 °C ... 50 °C
Weight, approx. [g]	47
Volume [ccm]	20.8

Dimensions [mm]

min: max:

A	46.5	48.5
D	-	46.4
E	12.45	12.95
O	24.5	26.5
P	15.5	17.5

Typical Capacities (at 20°C)

Discharge Type	Load	End Voltage[V]	7.5
24H/D,7D/W – 1S/1H,24H/1D	10000Ω - 620Ω	Time [h]	540
		Capacity [mAh]	448
		Energy [mWh]	3704
Smoke Detector			
Discharge Type	Load	End Voltage[V]	5.4
1H/D,7D/W	270 Ω	Time [h]	22
		Capacity [mAh]	610
		Energy [mWh]	4625
Toy			
Discharge Type	Load	End Voltage[V]	5.4
2H/D,7D/W	620 Ω	Time [h]	52,6
		Capacity [mAh]	640
		Energy [mWh]	4915
Radio			

* In consideration of typical loss of capacity at storage and application.

Information and contents in this data sheet are for reference purpose only.
They do not constitute any warranty or representation and are subject to change without notice.
For most current information and further details, please contact your VARTA representative.

VARTA Microbattery GmbH, VARTA-Platz 1, D-73479 Ellwangen/Jagst
Tel.: (+49) 7961/921-0, Telefax: (+49) 7961/921-2553

Subject to change without prior notice!
Date of issue: 2020-08-20

Primary Alkaline Manganese Cylindrical

Data Sheet

Type number	4103
Designation IEC System	LR03 Zn-MnO ₂ (Alkaline)
Shelf Life (Coding)*	7 years
Nominal Voltage [V]	1.5
Typical Capacity C [mAh]	1.200 (discharge with high-resistance)
Operating temperature:	- 20°C to 54°C (45 % - 85 % RH)
Storage temperature:	- 30°C to 45°C (45 % - 85 % RH)
Weight, approx. [g]	11
Volume [ccm]	3.8
Dimensions [mm]	

Typical Capacities (at 20°C)

Discharge Type	Load	End Voltage [V]	0.9
4 M/H, 8 H/D, 7 D/W	5.1 Ω	Time [m]	220
Portable Lighting			
Discharge Type	Load	End Voltage [V]	0.9
1 H/D, 7 D/W	10 Ω	Time [m]	480
Tape Recorders			
Discharge Type	Load	End Voltage [V]	0.9
4 H/D, 7 D/W	75 Ω	Time [h]	72.5
Transistor Radios			

* In consideration of typical loss of capacity at storage and application.

Primary Alkaline Manganese Cylindrical

Data Sheet

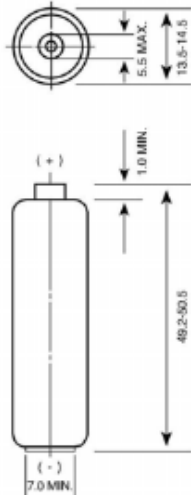
Type number	4106
Designation IEC System	LR6 Zn-MnO ₂ (Alkaline)
Shelf Life (Coding)*	7 years
Nominal Voltage [V]	1.5
Typical Capacity C [mAh]	2.600 (discharge with high-resistance)
Operating temperature:	- 20°C to 54°C (45 % - 85 % RH)
Storage temperature:	- 30°C to 45°C (45 % - 85 % RH)
Weight, approx. [g]	23
Volume [ccm]	7.69
Dimensions [mm]	

Typical Capacities (at 20°C)

Discharge Type	Load	End Voltage [V]	0.8
1 H/D, 7 D/W	3.9 Ω	Time [min]	430
Motor / Toy			
Discharge Type	Load	End Voltage [V]	0.9
1 H/D, 7 D/W	10 Ω	Time [h]	19.3
Personal Cassette Players/			
Discharge Type	Load	End Voltage [V]	0.9
4 H/D, 7 D/W	43 Ω	Time [h]	92.5
Transistor Radios			

* In consideration of typical loss of capacity at storage and application.

Primary Alkaline Manganese Cylindrical

Data Sheet

Type number	4114
Designation IEC System	LR14 Zn-MnO ₂ (Alkaline)
Shelf Life (Coding)*	7 years
Nominal Voltage [V]	1.5
Typical Capacity C [mAh]	7.800 (discharge with high-resistance)
Operating temperature:	- 20°C to 54°C (45 % - 85 % RH)
Storage temperature:	- 30°C to 45°C (45 % - 85 % RH)
Weight, approx. [g]	69
Volume [ccm]	26.5
Dimensions [mm]	

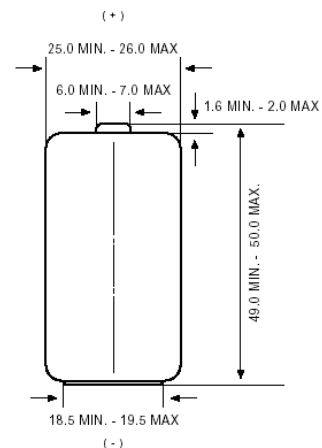

Typical Capacities (at 20°C)

<u>Discharge Type</u>	<u>Load</u>	<u>End Voltage [V]</u>	<u>0.9</u>
4 M/H, 8 H/D, 7 D/W	3.9 Ω	Time [h]	19
Portable Lighting			
<u>Discharge Type</u>	<u>Load</u>	<u>End Voltage [V]</u>	<u>0.9</u>
1 H/D, 7 D/W	3.9 Ω	Time [h]	22
Toys			
<u>Discharge Type</u>	<u>Load</u>	<u>End Voltage [V]</u>	<u>0.9</u>
4 H/D, 7 D/W	20 Ω	Time [h]	118
Transistor Radios			

* In consideration of typical loss of capacity at storage and application.

Primary Alkaline Manganese Cylindrical

Data Sheet

Type number	4120
Designation IEC System	LR20 Zn-MnO ₂ (Alkaline)
Shelf Life (Coding)*	7 years
Nominal Voltage [V]	1.5
Typical Capacity C [mAh]	16.500 (discharge with high-resistance)
Operating temperature:	- 20°C to 54°C (45 % - 85 % RH)
Storage temperature:	- 30°C to 45°C (45 % - 85 % RH)
Weight, approx. [g]	141
Volume [ccm]	51.3
Dimensions [mm]	

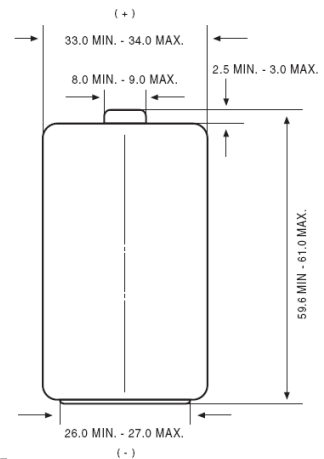

Typical Capacities (at 20°C)

Discharge Type	Load	End Voltage [V]	0.9
4 M/H, 8 H/D, 7 D/W	2.2 Ω	Time [h]	21.5

Portable Lighting

Discharge Type	Load	End Voltage [V]	0.8
1 H/D, 7 D/W	2.2 Ω	Time [h]	24

Toys

Discharge Type	Load	End Voltage [V]	0.9
4 H/D, 7 D/W	10 Ω	Time [h]	125

Transistor Radios

* In consideration of typical loss of capacity at storage and application.

Primary Alkaline Manganese Cylindrical

Data Sheet

Type number	4122
Designation IEC System	6LR61 Zn-MnO ₂ (Alkaline)
Shelf Life (Coding)*	7 years
Nominal Voltage [V]	9
Typical Capacity C [mAh]	550 (discharge with high-resistance)
Operating Temperature:	- 20 ~ 60°C, 65 % RH max.
Storage Temperature:	+10 ~ 25°C, 45 ~ 75 % RH.
Weight, approx. [g]	46
Volume [ccm]	20.8
Dimensions [mm]	

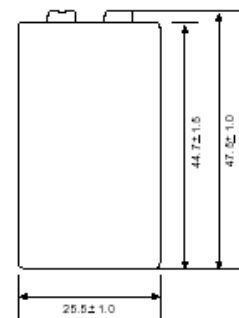
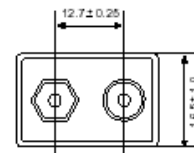

Typical Capacities (at 20°C)

Discharge Type	Load	End Voltage [V]	4.8
30 M/D, 7 D/W	180 Ω	Time [h]	14.2

Pocket Calculators

Discharge Type	Load	End Voltage [V]	5.4
1 H/D, 7 D/W	270 Ω	Time [h]	20

Toys

Discharge Type	Load	End Voltage [V]	5.4
2 H/D, 7 D/W	620 Ω	Time [h]	48.2

Transistor Radios

* In consideration of typical loss of capacity at storage and application.