

knitter-switch

Product-Change Notification

Products affected: KTT 107
KTT 204, KTT 206, KTT 208, KTT 209, KTT 217, KTT 227

Effective date: from date-code 1237 (week 37, 2012)

Details:

Due to a change of tolerances on assigned switches (TMP-series) the caps needed to be modified in the same way. The dimension 2.8 mm changes to 3.05 mm:

KTT 1xx

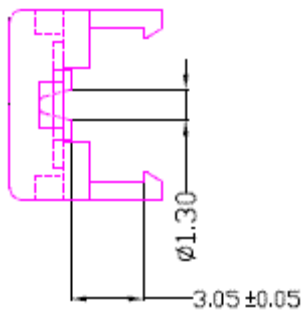

KTT 2xx

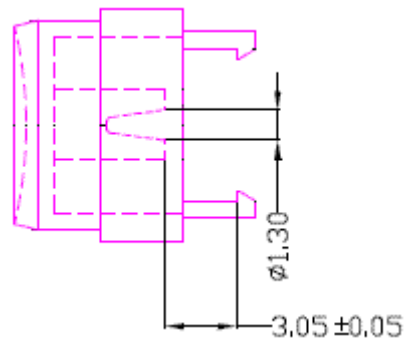

For easy visual identification of old and new version, the new caps have a 1.3 mm hole inside:

KTT 1xx

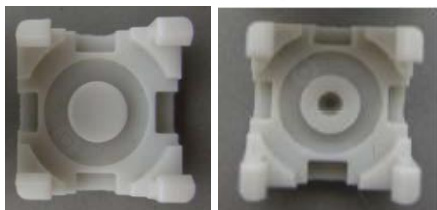

KTT 2xx

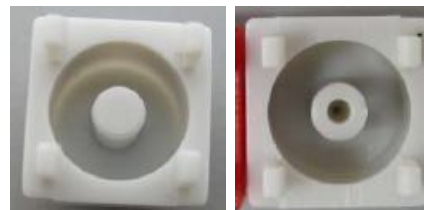

Knitter-switch, February 2013

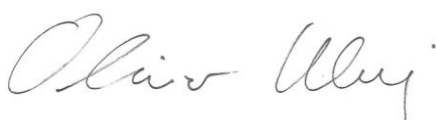

Oliver Kluj
Technical Director