

**TBH8xxAGN (5mm)  
TBH8xxBGN (10mm)**

**Horizontal  
Mounting**

**Dimensions (mm)**

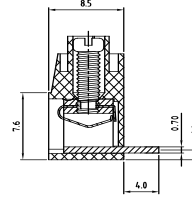
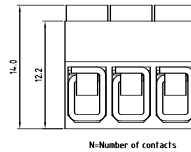
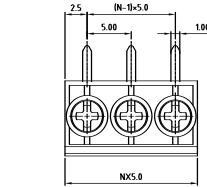

Drilling Diagram & Footprint (top view)

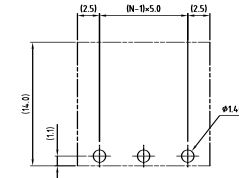

**WIRE GUARD** Terminal blocks with phosphor bronze wire guards. Choice of 5mm pitch or wider spaced 10mm pitch.

**KEY FEATURES/BENEFITS**

- ◆ 15A rating
- ◆ Solid blocks to maintain pitch integrity over longer lengths
- ◆ Combi screws as standard
- ◆ UL94V-0 flame retardant bodies
- ◆ Spring action wire guards permit wire re-insertion
- ◆ 10mm pitch offers improved isolation between terminals

**Options Available**

**Marked Blocks -**

A variety of markings and logos can be added to your requirements.

**Screws -**

Conventional slotted screws can be fitted in place of combi screws.

**Longer Blocks -**

Up to 24 ways can be supplied in 5mm pitch and up to 12 ways in 10mm pitch.

N.B. These options may be subject to minimum order quantities. Please contact our Sales Desk for further details.

**Ordering Information**

Poles/ Ways	TAICOM Part No.	
	5mm	10mm
2	TBH802AGN	TBH802BGN
3	TBH803AGN	TBH803BGN
4	TBH804AGN	TBH804BGN
5	TBH805AGN	TBH805BGN
6	TBH806AGN	TBH806BGN
7	TBH807AGN	TBH807BGN
8	TBH808AGN	TBH808BGN
9	TBH809AGN	TBH809BGN
10	TBH810AGN	TBH810BGN
11	TBH811AGN	TBH811BGN
12	TBH812AGN	TBH812BGN

N.B. Part numbers shown are for combi screws. For slotted screws add -1 to the end of the part number.

**NOTES**

10mm pitch has alternate pins omitted

**Specification**

**Materials**

Body mouldings	Grey (RAL7035/D) Polyamide
Terminal inserts/pins	Brass, tin plated
Screws	Steel, zinc plated
Wire guards	Phosphor bronze

**Ratings (limited by pcb)**

UL/cUL	UL/cUL
Current rating	10A/15A
Voltage rating	300Vac/250Vac
Test voltage	1.6kVac
Insulation resistance	20MΩ max
Operating temperature range	-30°C to +105°C
Soldering temperature	250°C ±10°C/5 sec

**Mechanical Data**

Wire size	12-22 awg/12-20 awg
Wire stripped length	6-7mm
Screw torque	3.5lb-In - 0.4Nm
Screw	M2.5 combi

**Approvals**

UL and cUL

For details of terminal blocks with alternative mounting orientations

**Vertical**  
refer to pages 2, 3 & 4

**45° Angle**  
refer to page 14

**Single Plane**  
refer to pages 15 & 16