

BOURNS type 3315

A range of miniature low cost incremental encoders with conductive plastic elements and quadrature outputs. Featuring industry standard 2.54mm side exit or 5.08mm rear exit terminals, the devices are suitable for bush or pcb mounting.

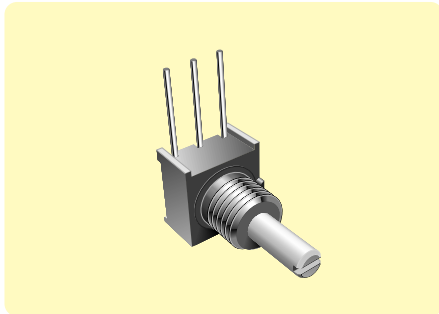

- ◆ Miniature 9mm square sealed package
- ◆ Quadrature output
- ◆ Conductive plastic element
- ◆ Long operating life
- ◆ Bush or pcb mounted
- ◆ Choice of terminal position
- ◆ Slotted 3.18mm (1/8 in) shaft

NEW

Specification

Electrical Characteristics

Resolution range 6 to 16PPR
 Output 2-bit gray code, Channel A leads Channel B electrically with clockwise rotation
 Closed circuit resistance 5Ω max.
 Contact rating 100mA at 16Vdc max. (TTL compatible loads)
 Insulation resistance 1,000MΩ min. at 500Vdc
 Dielectric withstand voltage 900Vac min.
 Electrical travel Continuous
 Contact bounce 5ms max. at 15rpm
 Operating rpm 120 max.

Environmental Characteristics

Temperature range -55°C to +125°C
 Vibration 30G
 Contact bounce 5ms max.
 Shock 100G
 Contact bounce 5ms max.

Mechanical Characteristics

Operating torque 3.5Ncm max.
 Mechanical rotation Continuous
 Rotational life
 6PPR 100,000 cycles
 16PPR 25,000 cycles

Resolution (Pulses Per Revolution)	Terminal Configuration	Manf. Part No. & Anglia Order Code
6	Side exit, 2.54mm in-line	3315C-001-006
	Rear exit, 5.08mm x 5.08mm triangular pattern	3315Y-001-006
16	Side exit, 2.54mm in-line	3315C-001-016
	Rear exit, 5.08mm x 5.08mm triangular pattern	3315Y-001-016

Dimensions (mm)

Side Exit Terminals

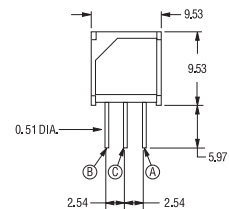
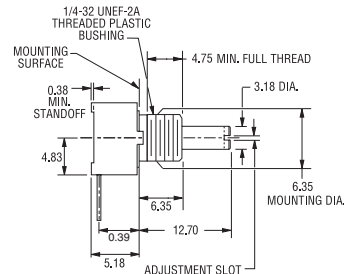

Rear Exit Terminals

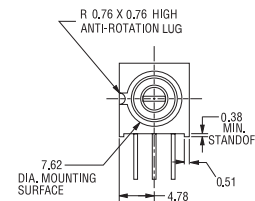
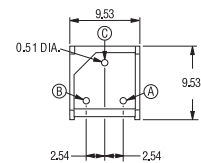
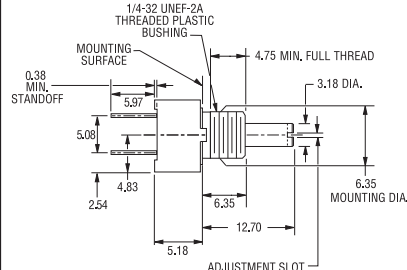

Incremental Control Diagram

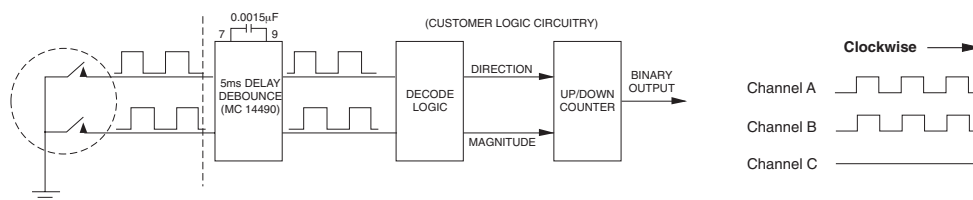

• Other bush, shaft and terminal styles available

Please contact our Sales Desk for details