

## PIHER type PT15 (15mm round)

A range of top or side adjust, single turn carbon element trimming potentiometers in a range of values from 100Ω to 10MΩ, with a power handling capability of 0.25W. The devices are manufactured with a polyester substrate, for enhanced stability and reliability, housed in a 15mm round dust proof enclosure. Adjustment may be made from either side, via a screwdriver slot, or by finger using thumbwheel or spindle actuators (supplied separately).



- ◆ Carbon element
- ◆ Polyester substrate
- ◆ 15mm round dust proof enclosure
- ◆ Top or side adjust, from either side
- ◆ Single turn
- ◆ Screwdriver or finger adjust
- ◆ Choice of actuators

### Specification

#### Electrical Characteristics

Resistance range .....	100Ω to 10MΩ
Resistance tolerance	
100Ω to 1MΩ .....	±20%
2.2MΩ to 4.7MΩ .....	±30%
10MΩ .....	+50, -30%
Equivalent noise resistance .....	≤3% or 3Ω (whichever is greater)
Resolution .....	Infinite
Effective travel .....	250° ±20°

#### Environmental Characteristics

Power rating .....	0.25W at 40°C max.
Max voltage .....	250Vdc
Temperature range .....	-25°C to +70°C
Temperature coefficient .....	±300ppm/°C
Humidity .....	95% RH 500 hours at 40°C
total resistance shift .....	5% max.
Vibration .....	20G 2 hours at 10Hz to 50Hz
total resistance shift .....	2% max.
Load life .....	1000 hours 0.25W at 40°C
total resistance shift .....	5% max.
contact resistance variation .....	5% max.
Rotational life .....	500 cycles (10-15 cycles/minute)
total resistance shift .....	3% max.
contact resistance variation .....	3% max.

#### Physical Characteristics

Operating torque .....	0.5 to 2.5Ncm
Stop torque .....	10Ncm min.
Wiper positioning .....	Set at CCW end
Flammability .....	UL94V-0

### Dimensions (mm)

#### PT15LV17/PT15NV17 - Top Adjust, Horizontal Mounting

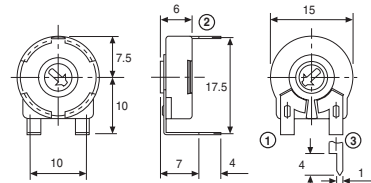

#### PT15LH5/PT15NH5 - Side Adjust, Vertical Mounting

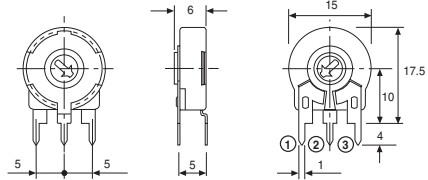

#### adjustment options

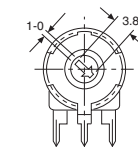

Screwdriver Adj. (slot)

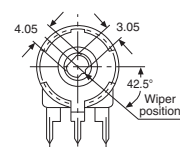

Finger Adj. (hole)  
for use with actuators detailed opposite

#### Footprint

##### Top Adjust

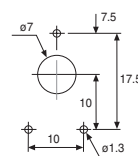

##### Side Adjust

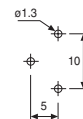

#### Circuit Diagram

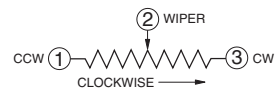

For the very latest information and news on the full range of PIHER products available from Anglia, visit our website :

[www.anglia.com/piher](http://www.anglia.com/piher)

Alternatively, contact our Sales Desk to discuss your specific requirements.

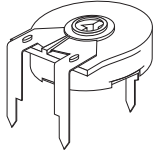
**PIHER type PT15 (15mm round)**
**PT15LV17 & PT15NV17**

PT15LV17

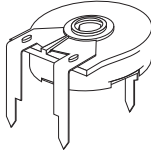

PT15NV17

**Top Adjust, Horizontal Mounting**

Value (Ω)	anglia Order Code	
	PT15LV17	PT15NV17
	(Screwdriver Adj.)	(Finger Adj.)*
100R	037101Z	037101A
220R	037221Z	037221A
470R	037471Z	037471A
1K	037102Z	037102A
2K2	037222Z	037222A
4K7	037472Z	037472A
10K	037103Z	037103A
22K	037223Z	037223A
47K	037473Z	037473A
100K	037104Z	037104A
220K	037224Z	037224A
470K	037474Z	037474A
1M	037105Z	037105A
2M2	037225Z	037225A
4M7	037475Z	037475A
10M	037106Z	037106A

\* Actuators supplied separately- see below

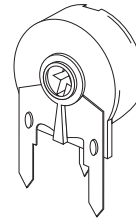
**PT15LH5 & PT15NH5**

PT15LH5

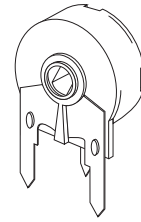

PT15NH5

**Side Adjust, Vertical Mounting**

Value (Ω)	anglia Order Code	
	PT15LH5	PT15NH5
	(Screwdriver Adj.)	(Finger Adj.)*
100R	038101Z	038101A
220R	038221Z	038221A
470R	038471Z	038471A
1K	038102Z	038102A
2K2	038222Z	038222A
4K7	038472Z	038472A
10K	038103Z	038103A
22K	038223Z	038223A
47K	038473Z	038473A
100K	038104Z	038104A
220K	038224Z	038224A
470K	038474Z	038474A
1M	038105Z	038105A
2M2	038225Z	038225A
4M7	038475Z	038475A
10M	038106Z	038106A

\* Actuators supplied separately- see below



**PIHER**

• Other configurations available

Please contact our Sales Desk for details

**Actuators type 5371, 5272, 5219, 5214, 5207 & 5216**

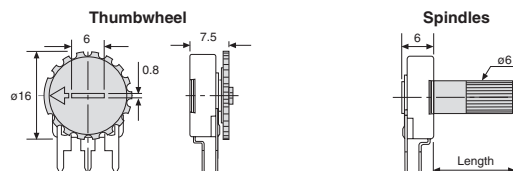
Moulded actuators for use with the finger adjust versions above. Choice of style and colour.

**Dimensions (mm)**

Actuator Style	Type	anglia Order Code		
		White	Black	Red
Thumbwheel	5371	037001	037002	037003
Spindle (12mm length)	5272	037008	037009	037010
Spindle (15mm length)	5219	037015	037016	037017
Spindle (19mm length)	5214	037022	037023	037024
Spindle (25.3mm length)	5207	037029	037030	037031
Spindle (35mm length)	5216	037036	037037	037038