

EXCEL type RA & RB

A range of radial lead, PTC resettable, general purpose fuses with flame retardant bodies. Designed for fast tripping, the devices are available in an array of holding current values between 0.1A and 9A and feature appropriate European and North American approvals on most variants.

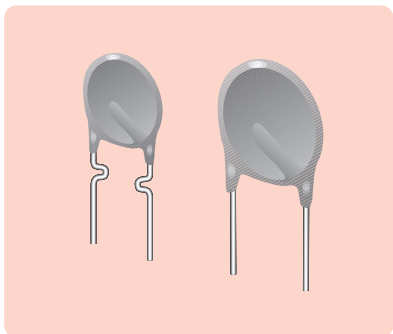

- ◆ Radial leaded
- ◆ Current ratings from 0.1A to 9A
- ◆ UL & TÜV approved
- ◆ Flame retardant to UL94V-0
- ◆ Supplied loose
- ◆ Taped and reeled packing available
- ◆ Competitively priced



Specification

Current rating (hold current).....	100mA ~ 9A (see table)
Maximum voltage	60V or 30V (see table)
Temperature range	-40°C to +85°C
Material.....	Cured, flame retardant epoxy polymer to UL94V-0

Dimensions (mm)

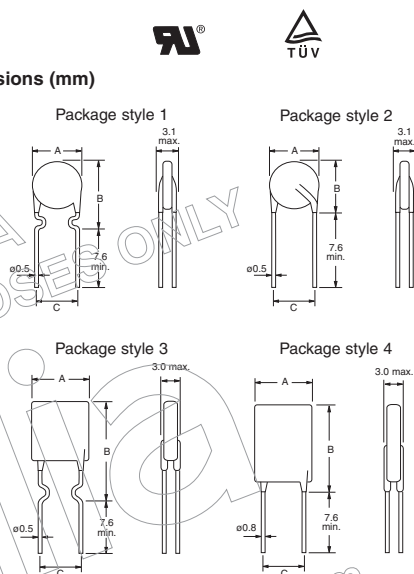

For the very latest information and news on the full range of ECE products available from Anglia, visit our website:

www.anglia.com/ece

Alternatively, contact our Sales Desk to discuss your specific requirements.

Current (A)	V Max. (V)	I Max. (A)	Initial Resistance (Ω)	1 hour Post Trip Res. (R, Ω)	Max. Time to Trip @ 5x Hold Current	Tripped Power Diss. (W)	Package Style	Dimensions (mm)			anglia Order Code
								A Max.	B Max.	C Nom.	
								@ 23°C			
0.10	0.20	60	2.50	7.50	4.0	0.38	1	7.4	12.7	5.1	700010
0.17	0.34	60	2.00	7.00	3.0	0.48	1	7.4	12.7	5.1	700017
0.20	0.40	60	1.83	4.40	2.2	0.41	1	7.4	12.7	5.1	700020
0.25	0.50	60	1.25	3.00	2.5	0.45	1	7.4	12.7	5.1	700025
0.30	0.60	60	0.88	2.10	3.0	0.49	1	7.4	13.0	5.1	700030
0.40	0.80	60	0.55	1.29	3.8	0.56	1	7.6	13.5	5.1	700040
0.50	1.00	60	0.50	1.17	4.0	0.77	1	7.9	13.7	5.1	700050
0.65	1.30	60	0.31	0.72	5.3	0.88	1	9.7	14.5	5.1	700065
0.75	1.50	60	0.25	0.60	6.3	0.92	1	10.4	15.2	5.1	700075
0.90	1.80	60	0.20	0.47	7.2	0.99	1	11.7	15.8	5.1	700090
1.10	2.20	60	0.15	0.38	8.2	1.50	2	13.0	18.0	5.1	700110
1.35	2.70	60	0.12	0.30	9.6	1.70	2	14.5	19.6	5.1	700135
1.60	3.20	60	0.09	0.22	11.4	1.90	2	16.3	21.3	5.1	700160
1.85	3.70	60	0.08	0.19	12.6	2.10	2	17.8	22.9	5.1	700185
2.50	5.00	60	0.05	0.13	15.6	2.50	2	21.3	26.4	10.2	700250
3.00	6.00	60	0.04	0.10	19.8	2.80	2	24.9	30.0	10.2	700300
3.75	7.50	60	0.03	0.08	24.0	3.20	2	28.5	33.5	10.2	700375
0.90	1.80	30	0.07	0.22	5.9	0.60	3	7.4	12.2	5.1	700090A
1.10	2.20	30	0.05	0.17	6.6	0.70	3	7.4	14.2	5.1	700110A
1.35	2.70	30	0.04	0.13	7.3	0.80	3	8.9	13.5	5.1	700135A
1.60	3.20	30	0.03	0.11	8.0	0.90	3	8.9	15.2	5.1	700160A
1.85	3.70	30	0.03	0.09	8.7	1.00	3	10.2	15.7	5.1	700185A
2.50	5.00	30	0.02	0.07	10.3	1.20	3	11.4	18.3	5.1	700250A
3.00	6.00	30	0.02	0.08	10.8	2.00	4	11.4	17.3	5.1	700300A
4.00	8.00	30	0.01	0.05	12.7	2.50	4	14.0	20.1	5.1	700400A
5.00	10.00	30	0.01	0.05	14.5	3.00	4	14.0	24.9	10.2	700500A
6.00	12.00	30	0.005	0.04	16.0	3.50	4	16.5	24.9	10.2	700600A
7.00	14.00	30	0.005	0.03	17.5	3.80	4	19.1	26.7	10.2	700700A
8.00	16.00	30	0.005	0.02	18.8	4.00	4	21.6	29.2	10.2	700800A
9.00	18.00	30	0.005	0.02	20.0	4.20	4	24.1	29.7	10.2	700900A

BOURNS type MF-R

MULTIFUSE®

A range of radial lead, PTC resettable, general purpose fuses with flame retardant bodies. Designed for fast tripping, the devices are available in an array of holding current values between 0.1A and 11A and feature appropriate European and North American approvals on most variants.

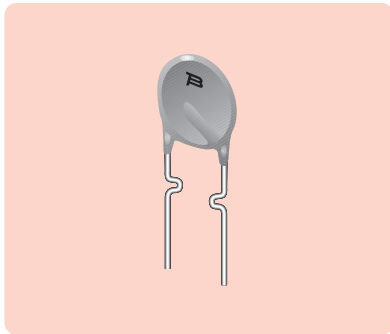

- ◆ Radial leaded
- ◆ Current ratings from 0.1A to 11A
- ◆ UL, CSA & TÜV approved
- ◆ Flame retardant to UL94V-0

Specification

Environmental Characteristics

Temperature range	-40°C to +85°C
storage.....	-40°C to +85°C
operating.....	-40°C to +85°C
Max. device surface temp.....	125°C (in tripped state)
Passive ageing.....	1000 hours/+85°C
Humidity ageing.....	±5% typ. resistance change 1000 hours/+85°C/85% R.H. ±5% typ. resistance change
Thermal shock.....	MIL-STD-202F, method 107G ±10% typ. resistance change (+125°C to -55°C, 10 times)
Mechanical shock.....	MIL-STD-202, method 213, Condition 1 (100g/6 seconds) No resistance change
Vibration.....	MIL-STD-883C, method 2007.1, Condition A No change
Solvent resistance.....	MIL-STD-202, method 215 No change



APPROVAL	FILE NUMBER
UL	E174545S
CSA	CA110338
TÜV	R2057213

Dimensions (mm)

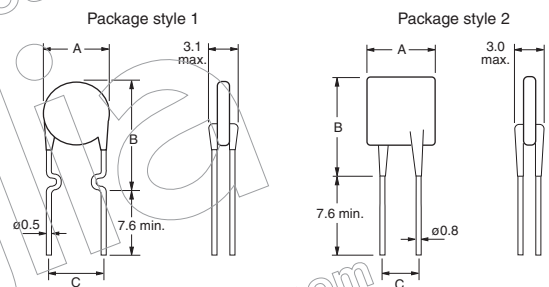

Current (A)	V Max. (V)	I Max. (A)	Initial Resistance (Ω)		1 Hour Post Trip Resistance (R _t Ω)	Max. Time to Trip @ 5x Hold Current (Secs.)	Tripped Power Dissipation (W)	Package Style	Dimensions (mm)			Manf. Part No. & Anglia Order Code	
			Min.	Max.					A Max.	B Max.	C Nom.		
*Tested at 40A													
*Tested at 23°C													
0.10	0.20	60	40	2.50	4.50	7.50	4.0	0.38	1	7.4	12.7	5.1	MF-R010
0.17	0.34	60	40	2.00	3.20	8.00	3.0	0.48	1	7.4	12.7	5.1	MF-R017
0.20	0.40	60	40	1.50	2.84	4.40	2.2	0.40	1	7.4	12.7	5.1	MF-R020
0.25	0.50	60	40	1.00	1.95	3.00	2.5	0.45	1	7.4	12.7	5.1	MF-R025
0.30	0.60	60	40	0.76	1.36	2.10	3.0	0.50	1	7.4	13.4	5.1	MF-R030
0.40	0.80	60	40	0.52	0.86	1.29	3.8	0.55	1	7.4	13.7	5.1	MF-R040
0.50	1.00	60	40	0.41	0.77	1.17	4.0	0.75	1	7.9	13.7	5.1	MF-R050
0.65	1.30	60	40	0.27	0.48	0.72	5.3	0.90	1	9.7	15.2	5.1	MF-R065
0.75	1.50	60	40	0.18	0.40	0.60	6.3	0.90	1	10.4	16.0	5.1	MF-R075
0.90	1.80	60	40	0.14	0.31	0.47	7.2	1.00	1	11.7	16.7	5.1	MF-R090
1.10	2.20	30	40	0.10	0.18	0.27	6.6	0.70	1	8.9	14.0	5.1	MF-R110
1.35	2.70	30	40	0.065	0.115	0.17	7.3	0.80	1	8.9	18.9	5.1	MF-R135
1.60	3.20	30	40	0.055	0.105	0.15	8.0	0.90	1	10.2	16.8	5.1	MF-R160
1.85	3.70	30	40	0.04	0.07	0.11	8.7	1.00	1	12.0	18.4	5.1	MF-R185
2.50	5.00	30	40	0.025	0.048	0.07	10.3	1.20	2	12.0	18.3	5.1	MF-R250
3.00	6.00	30	40	0.02	0.05	0.08	10.8	2.00	2	12.0	18.3	5.1	MF-R300
4.00	8.00	30	40	0.01	0.03	0.05	12.7	2.50	2	14.4	24.8	5.1	MF-R400
5.00	10.00	30	40	0.01	0.03	0.05	14.5	3.00	2	17.4	24.9	10.2	MF-R500
6.00	12.00	30	40	0.005	0.02	0.04	16.0	3.50	2	19.3	31.9	10.2	MF-R600
7.00	14.00	30	40	0.005	0.02	0.03	17.5	3.80	2	22.1	29.8	10.2	MF-R700
8.00	16.00	30	40	0.005	0.02	0.03	18.8	4.00	2	24.2	32.9	10.2	MF-R800
9.00	18.00	30	40	0.005	0.01	0.02	20.0*	4.20	2	24.2	32.9	10.2	MF-R900
11.00	22.00	16	100	0.003	0.01	0.014	20.0*	4.50	2	24.2	32.9	10.2	MF-R1100

Radial Lead Resettable Fuses continued overleaf > > >

BOURNS type MF-RX

MULTIFUSE®

Resettable radial lead fuses manufactured with the latest PTC technology and offering a range of holding current values from 1.1A to 3.75A. The fuses conform to appropriate European and North American approvals and have flame retardant bodies.

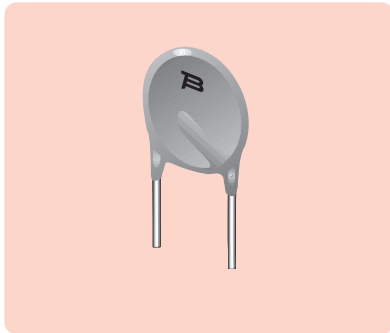

- ◆ Radial leaded
- ◆ Higher voltage
- ◆ Current ratings from 1.1A to 3.75A
- ◆ UL, CSA & TÜV approved
- ◆ Flame retardant to UL94V-0

Specification

Environmental Characteristics

Temperature range	-40°C to +85°C
storage	-40°C to +85°C
operating	-40°C to +85°C
Max. device surface temp	125°C (in tripped state)
Passive ageing	1000 hours/+85°C
	±5% typ. resistance change
Humidity ageing	1000 hours/+85°C/85% R.H.
	±5% typ. resistance change
Thermal shock	MIL-STD-202F, method 107G
	±10% typ. resistance change (+125°C to -55°C, 10 times)
Mechanical shock	MIL-STD-202, method 213 Condition 1 (100g/6 seconds)
	No change
Vibration	MIL-STD-883C, method 2007.1 Condition A
	No change
Solvent resistance	MIL-STD-202, method 215
	No change

APPROVAL	FILE NUMBER
UL	E174545S
CSA	CA110338
TÜV	R2057213

Current (A)		V Max. (V)	I Max. (A)	Initial Resistance (Ω)		1 Hour Post Trip Resistance (R ₁ Ω)	Max. Time to Trip @ 5x Hold Current	Tripped Power Dissipation (W)	Manf. Part No. & Anglia Order Code
@ 23°C				@ 23°C					
Hold	Trip			Min.	Max.	Max.	Secs.		
1.10	2.20	60	40	0.15	0.25	0.38	8.2	1.5	MF-RX110
1.35	2.70	60	40	0.12	0.19	0.30	9.6	1.7	MF-RX135
1.60	3.20	60	40	0.09	0.14	0.22	11.4	1.9	MF-RX160
1.85	3.70	60	40	0.08	0.12	0.19	12.6	2.1	MF-RX185
2.50	5.00	60	40	0.05	0.08	0.13	15.6	2.5	MF-RX250
3.00	6.00	60	40	0.04	0.06	0.10	19.8	2.8	MF-RX300
3.75	7.50	60	40	0.03	0.05	0.08	24.0	3.2	MF-RX375

Dimensions (mm)

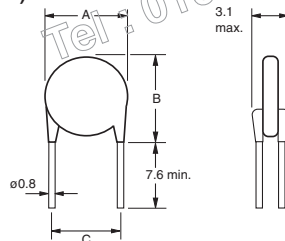

Part No.	A	B	C
	Max.	Max.	Nom.
MF-RX110	13.0	18.0	5.1
MF-RX135	14.5	19.6	5.1
MF-RX160	16.3	21.3	5.1
MF-RX185	17.8	22.9	5.1
MF-RX250	21.3	26.4	10.2
MF-RX300	24.9	30.0	10.2
MF-RX375	28.4	33.5	10.2



For the very latest information and news on the full range of BOURNS products available from Anglia, visit our website :

www.anglia.com/bourns

Alternatively, contact our Sales Desk to discuss your specific requirements.