

Microtron® - axial lead

Sub-miniature axial lead fuses suitable for applications where pcb space is limited. Quick blow with high breaking capacity. The hermetically sealed UL94V-0 moulded body offers environmental protection and a high temperature capability whilst allowing wave soldering / board washing. Markings are laser etched. Choice of loose product or taped and reeled.

PC-Tron® - radial lead

Sub-miniature radial lead fuses which offer high performance in a compact package. Ultra-fast acting with high breaking capacity and low I^2t giving excellent protection under short circuit conditions. Moulded body suitable for board washing. Choice of short (2.5mm) or long (19mm) leads on a 0.2in. (5mm) pitch. Supplied loose but available taped to special order. A pcb mounting socket, designed to accommodate the short lead fuses, is also available.

BUSSMANN type MCR

Quick Blow (F)

BUSSMANN type PC

Ultra-Fast (FF)

Dimensions (mm)

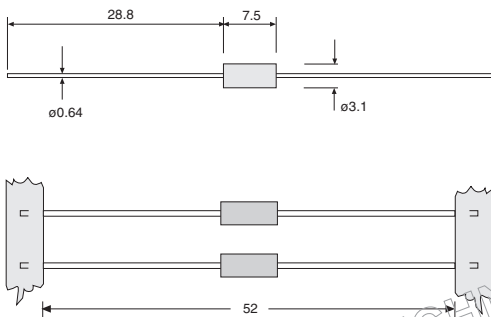

Dimensions (mm)

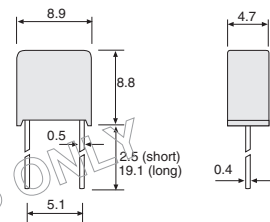

Specification

| | |
|-----------------------------|--|
| Voltage rating | 125Vac/dc (up to 5A) 60Vac/90Vdc (7, 10A) 50Aac/300Adc |
| Breaking capacity | 50Aac/300Adc |
| Opening times | 4 hr. min. at 100% 5 sec. max. at 250% |
| Operating temp. range | -55°C to +125°C |

Specification

| | |
|-----------------------------|---|
| Voltage rating | 250Vac (up to 3A) 125Vac (5A) 10,000A at 125Vac |
| Breaking capacity | 50A at 250Vac (up to 3A rating) |
| Opening times | 4 hr. min. at 100% 10 sec. max. at 200% |
| Operating temp. range | -55°C to +85°C |

| Current Rating | Cold Resistance Ω | Manf. Part No. | anglia Order Code | |
|----------------|--------------------------|----------------|-------------------|----------------|
| | | | Loose | Taped & Reeled |
| 63mA | 23 | MCR-1/16 | 647637 | 647637R |
| 125mA | 6.25 | MCR-1/8 | 647128 | 647128R |
| 250mA | 3.1 | MCR-1/4 | 647258 | 647258R |
| 375mA | 1.825 | MCR-3/8 | 647378 | 647378R |
| 500mA | 1.21 | MCR-1/2 | 647508 | 647508R |
| 750mA | 0.57 | MCR-3/4 | 647758 | 647758R |
| 1A | 0.178 | MCR-1 | 647109 | 647109R |
| 1.5A | 0.115 | MCR-1 1/2 | 647159 | 647159R |
| 2A | 0.0675 | MCR-2 | 647209 | 647209R |
| 2.5A | 0.0465 | MCR-2 1/2 | 647259 | 647259R |
| 3A | 0.040 | MCR-3 | 647309 | 647309R |
| 3.5A | 0.0343 | MCR-3 1/2 | 647359 | 647359R |
| 4A | 0.0265 | MCR-4 | 647409 | 647409R |
| 5A | 0.0212 | MCR-5 | 647509 | 647509R |
| 7A | 0.011 | MCR-7 | 647709 | 647709R |
| 10A | 0.0078 | MCR-10 | 647100 | 647100R |

| Current Rating | Cold Resistance Ω | Manf. Part No. | anglia Order Code | |
|----------------|--------------------------|----------------|-------------------|-----------|
| | | | Short Lead | Long Lead |
| 500mA | 1.4 | PC(C/B)-1/2 | 645508 | 645508L |
| 750mA | 0.72 | PC(C/B)-3/4 | 645758 | 645758L |
| 1A | 0.43 | PC(C/B)-1 | 645109 | 645109L |
| 1.5A | 0.24 | PC(C/B)-1 1/2 | 645159 | 645159L |
| 2A | 0.15 | PC(C/B)-2 | 645209 | 645209L |
| 2.5A | 0.10 | PC(C/B)-2 1/2 | 645259 | 645259L |
| 3A | 0.072 | PC(C/B)-3 | 645309 | 645309L |
| 5A | 0.023 | PC(E/D)-5 | 645509 | 645509L |

PCB SOCKET For use with above short lead fuses.

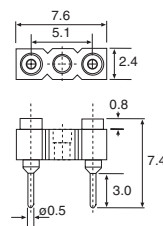

| Manf. Part No. | anglia Order Code |
|----------------|-------------------|
| PCS | 645000 |