

## PROFESSIONAL

## STANDARD

## STUDIOMATE type A20

A range of industry standard DIN plugs and sockets with a choice of socket mounting method.

### ELECTRICAL SPECIFICATION

<b>Cable Plugs</b>	
Current rating .....	1A (at 100Vac)
Withstand voltage .....	250Vac for 1 minute
Insulation resistance .....	100MΩ at 250Vdc
Initial contact resistance .....	≤10mΩ
<b>PCB Mounting Sockets</b>	
Current rating .....	1A (at 100Vac)
Withstand voltage .....	500Vac for 1 minute
Insulation resistance .....	100MΩ at 500Vdc
Initial contact resistance .....	≤30mΩ
<b>Panel Mounting Sockets</b>	
Current rating .....	1A (at 100Vac)
Withstand voltage .....	1000Vac for 1 minute
Insulation resistance .....	300MΩ at 500Vdc
Initial contact resistance .....	≤20mΩ

### MATERIALS

<b>Cable Plugs</b>	
Housing .....	PVA
Pin contacts .....	Brass, nickel plated
Shield contact .....	Brass, nickel plated
Insulator .....	PBT
Strain relief .....	PVC
<b>PCB Mounting Sockets</b>	
Housing .....	PBT
Terminals/contacts .....	Brass, Pb/Sn plated
Backplate .....	Phenolic resin
<b>Panel Mounting Sockets</b>	
Housing .....	Steel, nickel plated
Terminals/contacts .....	Brass, Pb/Sn plated
Insulator .....	PBT
Earthing pin rivet .....	Aluminium nickel plated

### CABLE PLUGS

Insulated plugs with a black plastic shell and integral strain relief. Two piece nickel plated brass barrel forms an electrical shield around the pin base. Available in the most popular contact configurations.

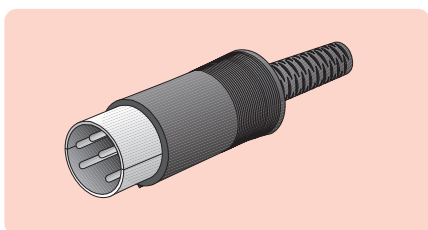

#### Type

- 3 Pole
- 5 Pole 180°
- 5 Pole 240°
- 6 Pole
- 7 Pole
- 8 Pole

#### Manf. Part No. & Anglia Order Code

- A20M103**
- A20M125**
- A20M135**
- A20M106**
- A20M107**
- A20M108**

#### Dimensions (mm)

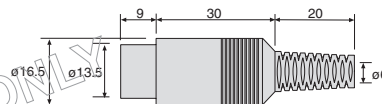

#### Plug Contact Configurations (face view)

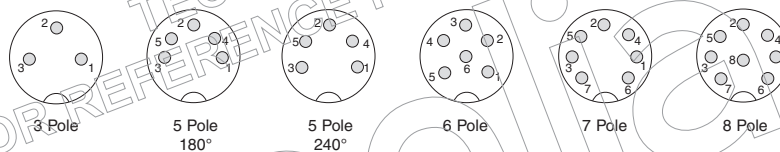

### PCB MOUNTING SOCKETS

Right angle pcb sockets with black moulded bodies incorporating interlocking side flanges (except 5 pin 240°) making them ideal for side stacking. Industry recognised footprints with front pins on 10mm centres (5 pin 240° on 5mm centres).

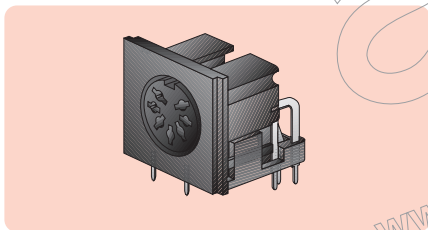

#### Type

- 3 Pole
- 4 Pole
- 5 Pole 180°
- 5 Pole 240°
- 6 Pole
- 7 Pole
- 8 Pole

#### Manf. Part No. & Anglia Order Code

- A20F503**
- A20F504**
- A20F525**
- A20F535**
- A20F506**
- A20F507**
- A20F508**

#### Dimensions (mm)

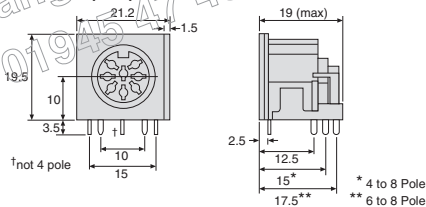

All types (except 5 pin 240°)

#### Socket Contact Configurations (face view)

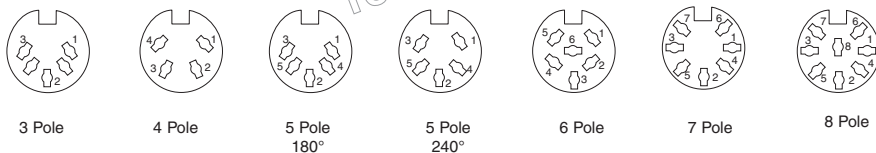

### PANEL MOUNTING SOCKETS

A range of cost effective, metal flanged sockets available in the most popular configurations. Industry standard panel mounting.

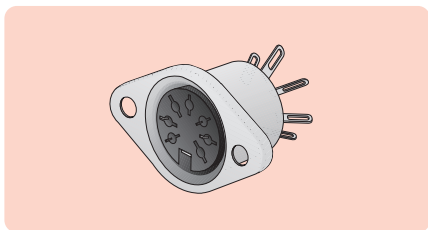

#### Type

- 3 Pole
- 4 Pole
- 5 Pole 180°
- 6 Pole
- 7 Pole
- 8 Pole

#### Manf. Part No. & Anglia Order Code

- A20F303**
- A20F304**
- A20F325**
- A20F306**
- A20F307**
- A20F308**

#### Dimensions (mm)

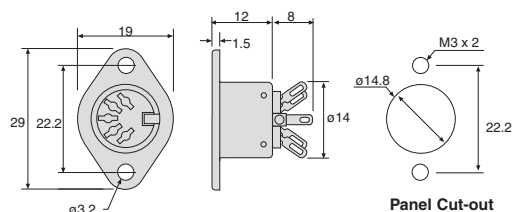

Panel Cut-out

**PROFESSIONAL**

**MINIATURE**

**STUDIOMATE type A21**

A miniature range of DIN plugs and sockets (Mini DIN) ideal for applications where space is at a premium.

**ELECTRICAL SPECIFICATION**

<b>Cable Plugs</b>	
Current rating.....	1A (at 50Vac)
Withstand voltage.....	500Vac for 1 minute
Insulation resistance.....	50MΩ at 250Vdc
Initial contact resistance.....	≤30mΩ
<b>PCB Mounting Sockets</b>	
Current rating.....	1A (at 100Vac)
Withstand voltage.....	1000Vac for 1 minute
Insulation resistance.....	500MΩ at 500Vdc
Initial contact resistance.....	≤30mΩ

**MATERIALS**

<b>Cable Plugs</b>	
Housing.....	ABS resin
Pin contacts.....	Brass, nickel plated
Shield contact.....	Brass, nickel plated
Insulator.....	PBT
Strain Relief.....	PVC
<b>PCB Mounting Sockets</b>	
Housing.....	PBT
Terminals/contacts.....	Brass, tin/gold plated
Shield.....	Tin, nickel plated

**CABLE PLUGS**

Insulated plugs available in three to eight pole configurations. Black ABS resin body fitted with integral PVC strain relief. Nickel plated brass pin contacts with PBT insulators.



**Type**

- 3 Pole
- 4 Pole
- 5 Pole
- 6 Pole
- 7 Pole
- 8 Pole

**Manf. Part No. & Anglia Order Code**

- A21M103**
- A21M104**
- A21M105**
- A21M106**
- A21M107**
- A21M108**

**Dimensions (mm)**

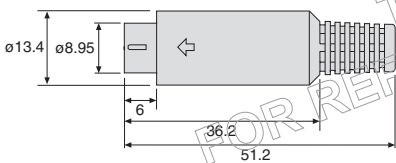

**Plug Contact Configurations (face view)**

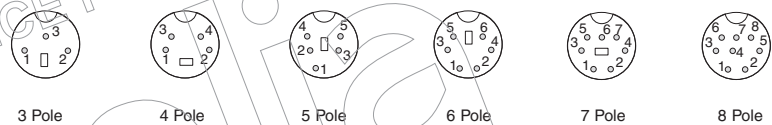

**PCB MOUNTING SOCKETS**

Shielded right angle pcb sockets available in three to eight pole configurations. Gold plated contacts offer high operational conductivity.

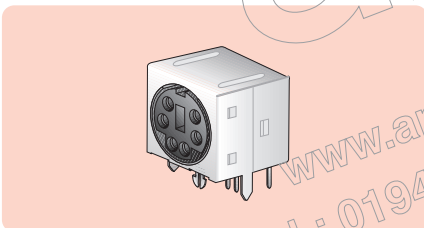

**Type**

- 3 Pole
- 4 Pole
- 5 Pole
- 6 Pole
- 7 Pole
- 8 Pole

**Manf. Part No. & Anglia Order Code**

- A21K503**
- A21K504**
- A21K505**
- A21K506**
- A21K507**
- A21K508**

**Dimensions (mm)**

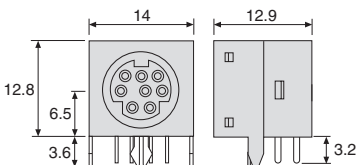

**Footprints (pin view)**

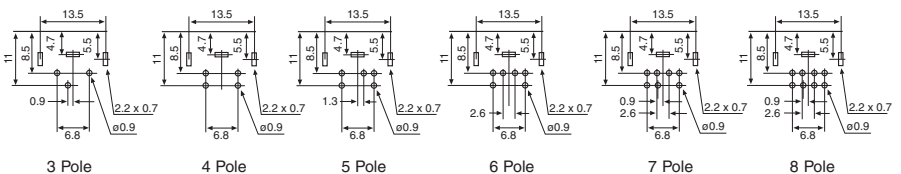

**Socket Contact Configurations (face view)**

