

PROFESSIONAL

STUDIOMATE type A35/36

A range of quality phono connectors consisting of cable mounting plugs (3 body styles) and single sockets (2 mounting styles), all available in a choice of colours. In addition a wide variety of pcb sockets are listed on the opposite page covering single, dual and quad configurations.

ELECTRICAL SPECIFICATION

Current rating	2A
Working voltage	34Vac/dc
Withstand voltage	250Vac for 1 minute
Insulation resistance.....	≥100MΩ @ 500Vdc
	≥100MΩ @ 250Vdc (A35L)

PLUGS

INSULATED (general purpose)

Solder terminals with integral cable clamp and insulated (moulded) threaded body with choice of colour.

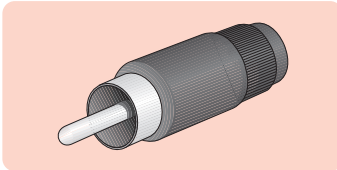

Type

- Black
- Red
- Yellow
- White

Manf. Part No. & anglia Order Code

- A35M100
- A35M120
- A35M140
- A35M190

Dimensions (mm)

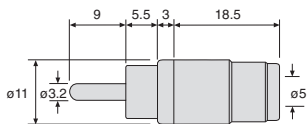

SCREENED (general purpose)

Solder terminals with integral cable clamp. Nickel plated brass body incorporates PVC cable strain relief. Choice of fixed colour coding insert.

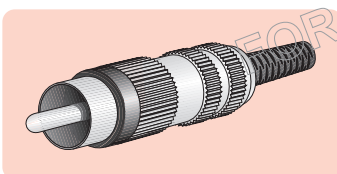

Type

- Black
- Red
- Yellow
- White

Manf. Part No. & anglia Order Code

- A35L100
- A35L120
- A35L140
- A35L190

Dimensions (mm)

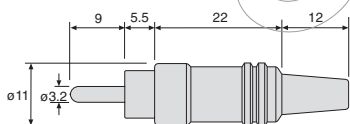

SCREENED (professional/robust body)

High quality enhanced 6-piece construction incorporating a captive pin and precision machined nickel plated brass body. Gold plated pin and shield contact. Solder terminal with gold plated cable clamp. Choice of fixed colour coding ring.

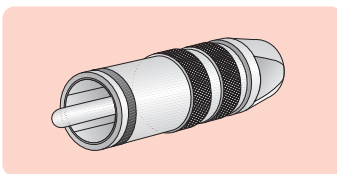

Type

- Black
- Red

Manf. Part No. & anglia Order Code

- A36L100
- A36L120

Dimensions (mm)

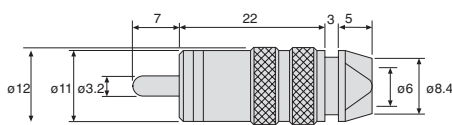

MATERIALS

General Purpose Plugs

Housing	ABS resin (A35M)
	brass, nickel plated (A35L)
Pin contact	Brass, nickel plated
Shield contact	Steel, nickel plated

Professional/Robust Body Plugs

Housing	Brass, nickel plated
Pin contact	Brass, gold plated
Shield contact	Brass, gold plated
Insulator	PTFE
Cable clamp	Brass, gold plated

Cable & Panel Mounting Single Sockets

Housing	ABS resin
Contact	Brass, nickel plated (A35F1)
	Steel, nickel plated (A35F3)
	Steel, gold plated (A35F3G)
Insulator	ABS resin (A35F1)

PCB Mounting Single Sockets

Housing	ABS resin
Centre contact	Brass, Sn/Pb plated
Outer contact	Brass, nickel plated

Nickel Plated Dual/Quad Sockets

Housing	ABS resin
Centre contact	Brass, Sn/Pb plated
Outer contact	Brass, nickel plated

Gold Plated Dual/Quad Sockets

Housing	ABS resin
Centre contact	Brass, nickel/gold plated
Outer contact	Brass, nickel/gold plated

SINGLE SOCKETS

CABLE MOUNTING

Line sockets with solder terminals, integral cable clamp and insulated (moulded) threaded body with choice of colour.

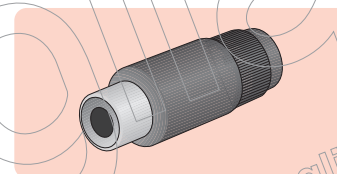

Type

- Black
- Red
- Yellow
- White

Manf. Part No. & anglia Order Code

- A35F100
- A35F120
- A35F140
- A35F190

Dimensions (mm)

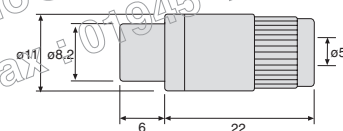

PANEL MOUNTING

Metal bodies with choice of insulator colour. Available either nickel plated or gold plated. Supplied complete with nut, washer and solder tag. Single hole fixing to suit M6 clearance hole.

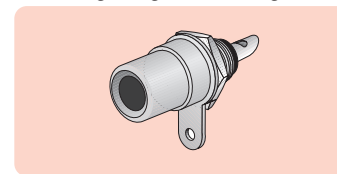

Type

- NICKEL**
- Black
- Red
- Yellow
- White
- GOLD**
- Black
- Red
- Yellow
- White

Manf. Part No. & anglia Order Code

- A35F300
- A35F320
- A35F340
- A35F390
- A35F300G
- A35F320G
- A35F340G
- A35F390G

Dimensions (mm)

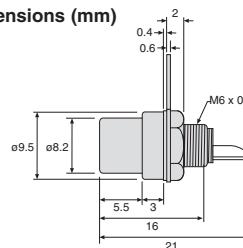

OTHER COLOUR OPTIONS available to special order

PROFESSIONAL

PCB SOCKETS

STUDIOMATE type A35

SINGLE

Right angle pcb mounting sockets with choice of switched or unswitched contacts. All types have insulated (moulded) bodies and bright nickel plated barrels.

Switched

Choice of two sizes, both having a single normally closed contact. The smaller version has 3 hole mounting while the larger body size has 6 hole mounting. Insulator colour black.

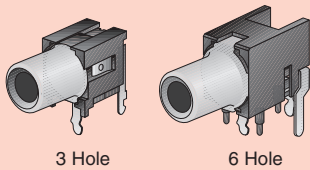

Type

3 Hole Mount
6 Hole Mount

Manf. Part No. & Anglia Order Code

A35F520
A35F510

Dimensions (mm)

3 Hole Mount

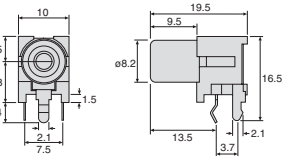

Footprint (pin view)

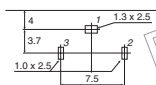

schematic



6 Hole Mount

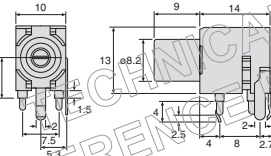

Footprint (pin view)

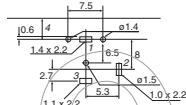

Unswitched

5 hole mounting. Insulator colour black.

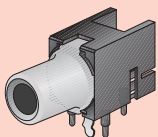

Manf. Part No. & Anglia Order Code

A35F500

Dimensions (mm)

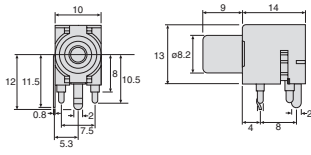

schematic



Footprint (pin view)

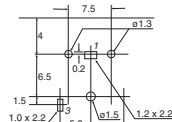

For commercial grade versions, see page 253

DUAL & QUAD

A range of right angle pcb mounting sockets with a choice of dual or quad contact configurations. The dual version is available with nickel or gold plated contacts and red/white inserts. The quad variants offer the same nickel or gold contact options with the nickel version supplied in red/white, and the gold version all black inserts.

DUAL

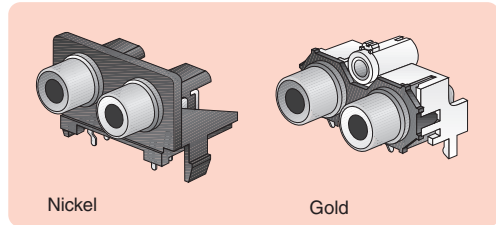

Nickel

Gold

Dimensions (mm)

Nickel

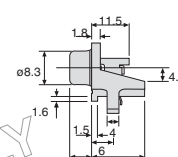
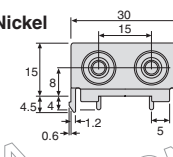

schematic

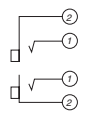

Gold

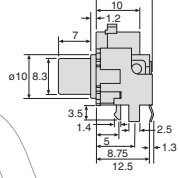
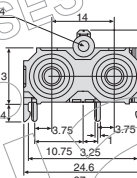

schematic

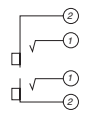

Type
Insert colour
Left/Right

Nickel
Gold

Red/White
Red/White

Manf. Part No. & Anglia Order Code

A35D529
A35D529AG

QUAD

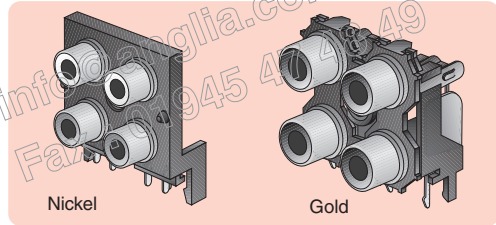

Nickel

Gold

Dimensions (mm)

Nickel

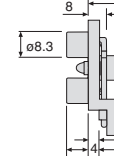
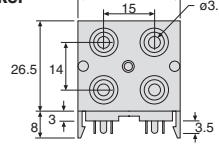

schematic

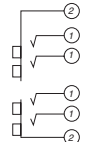

Gold

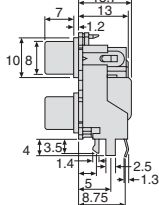
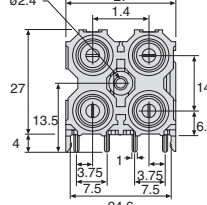

schematic

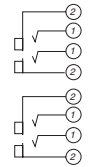

Type
Insert colour
Lower/Upper

Nickel
Gold

Red/White
Black/Black

Manf. Part No. & Anglia Order Code

A35E529
A35E500AG