



## Nickel Metal Hydride (NiMH)

A series of rechargeable 1.2 Volt nickel metal hydride cells offering a superior performance over nickel cadmium (NiCd). Free of cadmium and mercury, these environmentally friendly products exhibit similar discharge characteristics to NiCd but have double the energy capacity and do not suffer from the memory effect. Available in a wide selection of standard and industrial sizes, many offering a choice of capacity. A terminal style option is provided on the industrial versions to assist in the assembly of battery packs. Supplied with only a residual charge, all batteries should be fully charged before use. **DO NOT SHORT CIRCUIT.**

- ◆ Rechargeable, 1.2 Volt nickel metal hydride cells
- ◆ Environmentally friendly
- ◆ Superior performance over NiCd - double the energy density - no memory effect
- ◆ Wide selection of sizes & capacities
- ◆ High discharge versions available

### Standard (Consumer)

A range of cells compatible in size and style with the popular, non-rechargeable consumer types together with a PP3 size 9V prismatic battery. Designed for use with battery holders and connectors (see pages 22-24 & 28 for suitable products).

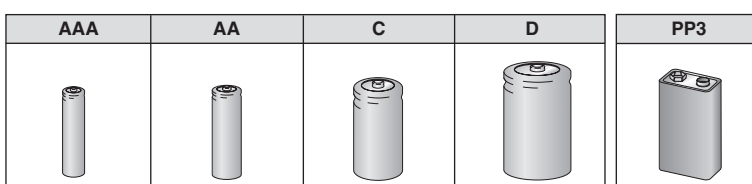

Case Style - for comparison purposes only. Not to scale.

Size	Nominal Capacity (mAh)	Dimensions (mm) Dia. x L	Weight approx. (g)	Charge Rate (mA)		Manf. Part No. & anglia Order Code
				Standard (0.1C/15hrs)	Fast* (1C/1.2hrs)	
AAA	600	10.5 x 44.5	12	60	600	H-AAA600A
	650		13	65	650	H-AAA650A
AA	800	14.5 x 50.5	25	80	800	H-AA800A
	1200		25	120	1200	H-AA1200A
	1300		26	130	1300	H-AA1300A
	1400		28	140	1400	H-AA1400A
	1500		28	150	1500	H-AA1500A
	1600		28	160	1600	H-AA1600A
	1700		28	170	1700	H-AA1700A
	1800		28	180	1800	H-AA1800A
	1900		28	190	1900	H-AA1900A
	2000		29	200	2000	H-AA2000A
2300	30	2300	2300	H-AA2300A		
C	1500	26 x 50.5	42	150	1500	H-C1500A
	1800		42	180	1800	H-C1800A
	3000		75	300	3000	H-C3000A
	3300		75	330	3300	H-C3300A
	3500		75	350	3500	H-C3500A
D	1800	33 x 61.5	76	180	1800	H-D1800A
	2200		76	220	2200	H-D2200A
	6500		160	650	6500	H-D6500A
	7000		160	700	7000	H-D7000A
PP3 9V prismatic battery	170	W x D x L 26.4 x 15.7 x 48.4	32	17 (14hrs)	170	H-PP3A170

### Terminal Style

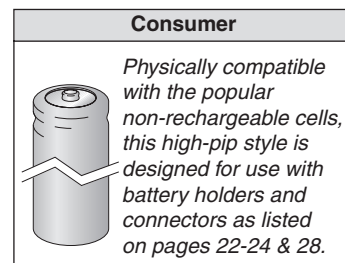

\* Under charge termination control

### Non-Rechargeable Cells

AAA AA C D PP3

consumer types in ZnCl or MnO<sub>2</sub> see page 9

### Battery Holders & Connectors



see pages 22-24 & 28



Nickel Metal Hydride (NiMH) continued

Industrial

An extensive range of industrial cells offering a wide variety of sizes together with a series of high discharge types. Suitable for use in the assembly of battery packs, the option of plain or solder tag terminals is provided throughout.

Size	Nominal Capacity (mAh)	Dimensions (mm) Dia. x L	Weight approx. (g)	Charge Rate (mA)		Manf. Part No. & Anglia Order Code	
				Standard (0.1C/15hrs)	Fast* (1C/1.2hrs)	Plain Terminals	Solder Tag Terminals
AAA	600	10.5 x 43.5	12	60	600	H-AAA600B	H-AAA600TO
	650		13	65	650	H-AAA650B	H-AAA650TO
2/3AA	600	14.5 x 29	14	60	600	H-2/3AA600	H-2/3AA600TO
4/5AA	1200	14.5 x 43	22	120	1200	H-4/5AA1200	H-4/5AA1200TO
AA	800	14.5 x 49	25	80	800	H-AA800B	H-AA800TO
	1200		25	120	1200	H-AA1200B	H-AA1200TO
	1300		26	130	1300	H-AA1300B	H-AA1300TO
	1400		28	140	1400	H-AA1400B	H-AA1400TO
	1500		28	150	1500	H-AA1500B	H-AA1500TO
	1600		28	160	1600	H-AA1600B	H-AA1600TO
	1700		28	170	1700	H-AA1700B	H-AA1700TO
	1800		28	180	1800	H-AA1800B	H-AA1800TO
	1900		29	190	1900	H-AA1900B	H-AA1900TO
	2000		29	200	2000	H-AA2000B	H-AA2000TO
2300	30	230	2300	H-AA2300B	H-AA2300TO		
2/3AF	1000	17 x 28	21	100	1000	H-2/3A1000	H-2/3A1000TO
4/5AF	1800	17 x 43	32	180	1800	H-4/5A1800	H-4/5A1800TO
AF	2300	17 x 50	37	230	2300	H-A2300	H-A2300TO
7/5AF	3500	17 x 67	51	350	3500	H-7/5A3500	H-7/5A3500TO
	3700		52	370	3700	H-7/5A3700	H-7/5A3700TO
18650	4100	18 x 67	60	410	4100	H-1865	H-1865TO
SUB-C	2200	23 x 43	57	220	2200	H-SC2200	H-SC2200TO
	3000		58	300	3000	H-SC3000	H-SC3000TO
C	1500	26 x 50	42	150	1500	H-C1500B	H-C1500TO
	1800		42	180	1800	H-C1800B	H-C1800TO
	3000		75	300	3000	H-C3000B	H-C3000TO
	3300		75	330	3300	H-C3300B	H-C3300TO
	3500		75	350	3500	H-C3500B	H-C3500TO
D	1800	33 x 60.5	76	180	1800	H-D1800B	H-D1800TO
	2200		76	220	2200	H-D2200B	H-D2200TO
	6500		160	650	6500	H-D6500B	H-D6500TO
	7000		160	700	7000	H-D7000B	H-D7000TO

See page overleaf for Case and Terminal Styles

\* Under charge termination control

High Discharge Range

Industrial SUB-C size, high capacity cells developed specifically for high current discharge applications (5C to 10C rates).

Size	Nominal Capacity (mAh)	Dimensions (mm) Dia. x L	Weight approx. (g)	Charge Rate (mA)		Manf. Part No. & Anglia Order Code	
				Standard (0.1C/15hrs)	Fast* (1C/1.2hrs)	Plain Terminals	Solder Tag Terminals
4/5SUB-C	1800	23 x 34	43	180	1800	H-4/5SC1800P	H-4/5SC1800PTO
SUB-C	2200	23 x 43	58	220	2200	H-SC2200P	H-SC2200PTO
	2500		58	250	2500	H-SC2500P	H-SC2500PTO
	3000		58	300	3000	H-SC3000P	H-SC3000PTO

See page overleaf for Case and Terminal Styles

\* Under charge termination control

Nickel Metal Hydride Cells & Batteries continued overleaf > > > >

**Nickel Metal Hydride (NiMH)** continued



**Industrial** continued

### Case Styles

For comparison purposes only. Not to scale.

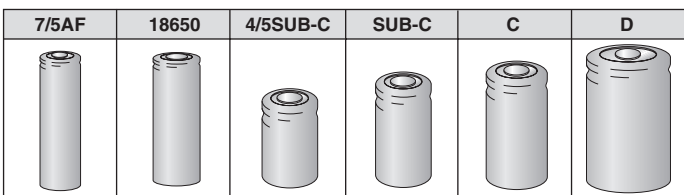
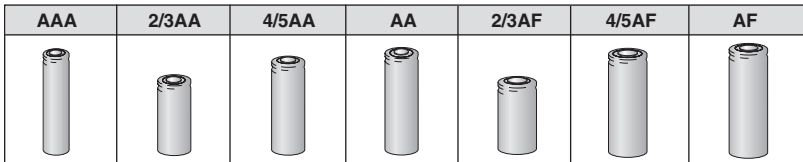

### Terminal Styles

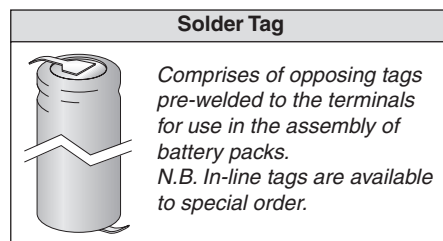
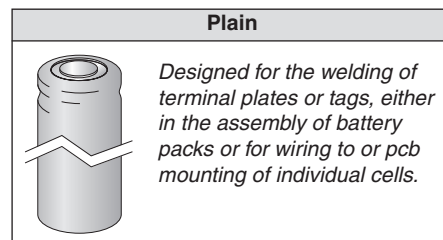

### NiCd Battery Packs

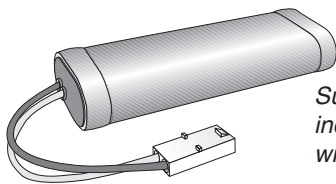

Supplied pre-assembled in popular industry styles or to your requirements, with or without connectors

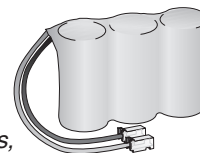

Refer to page 18 for details

## BUTTON CELL BATTERY PACKS

**Nickel Metal Hydride (NiMH)**



PCB mounting, button cell battery packs from GP, designed for many memory back-up applications or for use in portable equipment. The composition of the batteries can deliver up to 40% more capacity than equivalent nickel cadmium cells of similar size and retain at least 40% capacity after storage for 1 year at room temperature.

Pack Type	Fig.	Voltage (V)	Nominal Capacity (mAh)	Weight (g)	Body W/dia.	H	Manf. Part No.	anglia Order Code
1 Cell	A	1.2	80	3.7	15.5	17	GP80BVH1A3H	724014T
2-Cell	B	2.4	80	7.4	15.5	17	GP80BVH2A2H	724024W
2 Cell	C	2.4	40	3.4	11.6	13.5	GP40BVH2A3H	724023T
2 Cell	C	2.4	80	7.4	15.5	17	GP80BVH2A3H	724024T
3-Cell	D	3.6	80	11.1	15.5	17	GP80BVH3A2H	724034W
3-Cell	E	3.6	35	5.1	11.6	13.5	GP35BVH3A3H	724033T
3-Cell	E	3.6	80	11.1	15.5	17	GP80BVH3A3H	724034T
3-Cell	E	3.6	170	29.8	25.5	27	GP170BVH3A3H	724036T

Other configurations, capacities and terminal arrangements available to special order.

Dimensions (mm)

